

THIS SHEET INCLUDES FITTING INSTRUCTIONS FOR THE FOLLOWING PARTS:

Secondary Alternator Cover Part No. EC-RSV4-2010-1-MSO / Secondary Clutch Cover Part No. EC-RSV4-2010-2-MSO /
Bullet Frame Race Slider Set - RACE - Part No. FS-RSV4-2010-R
Paddock Stand / Bobbin Set Part No. BA12-6-RSV4-MSO-SET



Please note: For the 2017 model onwards, the **alternator** and **clutch** have a standard dust cover fitted to brackets.
The fixing studs and brackets will need to be removed before fitting the MSO alternator / clutch cover. (For clutch: **See Fig. 2 below**).

SECONDARY ALTERNATOR COVER PART NO. EC-RSV4-2010-1-MSO

Fits 2010-2020 models only. Alternator cover does not fit 2021 model

- 1 Remove 4 existing bolts from the stock Alternator cover, shown as position Bolt 1, 2 3 & 4.
Retain stock bolt washers.
- 2 Place the Secondary Alternator Cover over the stock cover.
- 3 Assemble 4 replacement bolts, reuse stock bolt washers, loosely in the correct position as shown.
The retained stock washers are fitted between the engine casing and the Motoshed cover - See Fig. 1.

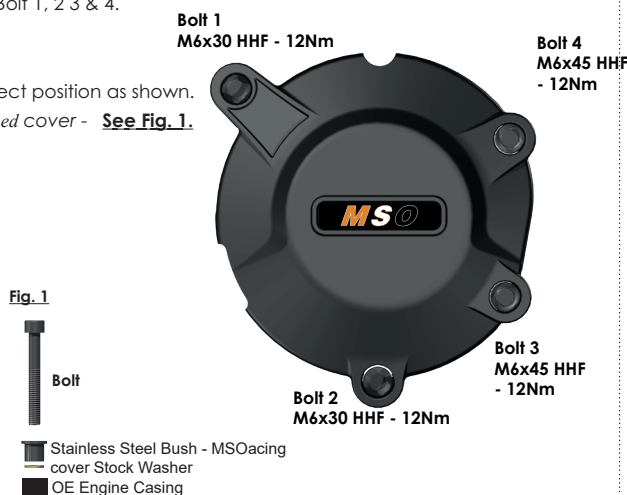
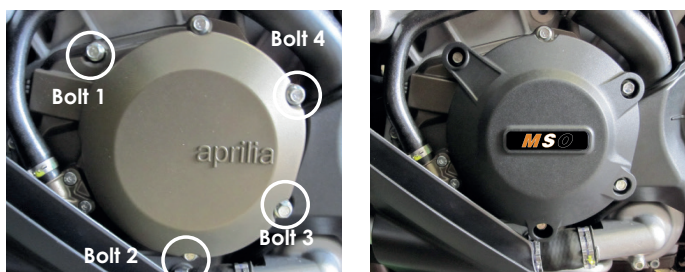

SECONDARY CLUTCH COVER PART NO. EC-RSV4-2010-2-MSO

See note at top of page re dust cover

- 1 Remove 3 existing bolts from the stock Clutch cover, shown as position Bolt 1, 2 & 3. Retain stock bolt washers.
- 2 Place the Secondary Clutch Cover over the stock cover.
- 3 Assemble 3 replacement bolts, reuse stock bolt washers loosely in the correct position as shown. *The retained stock washers are fitted between the engine casing and the Motoshed cover - See Fig. 1.*
- 4 Tighten bolts to a Torque of 12Nm as per Manufacturer's recommendations. **DO NOT OVERTIGHTEN.**

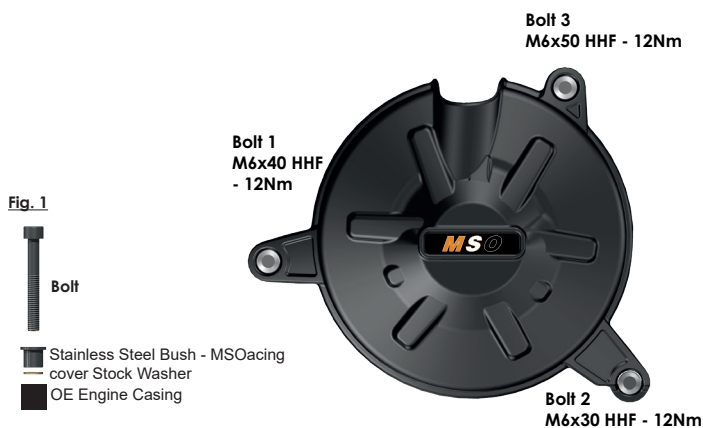
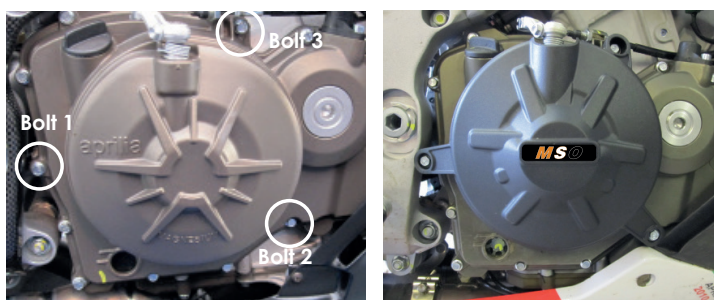

Fig 2

